

ZARF2068-L-TV

Needle roller/axial cylindrical roller bearing

Schaeffler ID:
0016821050000

Needle roller/axial cylindrical roller bearings ZARF...-L, double direction, for screw mounting, long shaft locating washer

Technical information

Main Dimensions & Performance Data

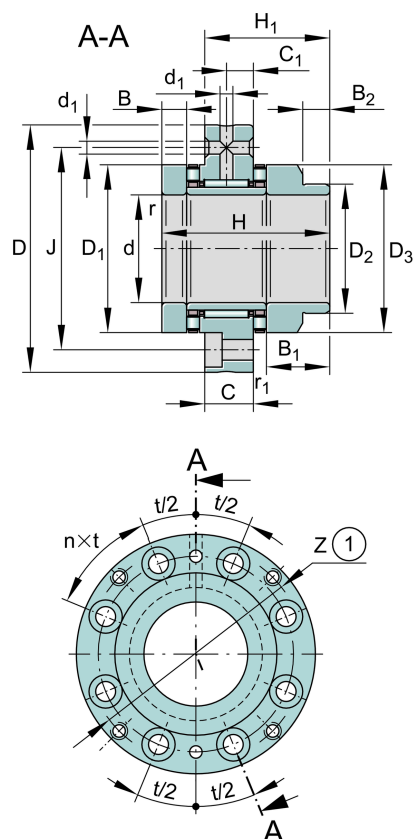

d	20 mm	Bore diameter
D	68 mm	Outside diameter
H	60 mm	Height
C_a	33.500 N	Basic dynamic load rating, axial
C_{0a}	76.000 N	Basic static load rating, axial
C_r	14.900 N	Basic dynamic load rating, radial
C_{0r}	22.400 N	Basic static load rating, radial
C_{ua}	6.400 N	Fatigue load limit, axial
C_{ur}	3.400 N	Fatigue load limit, radial
$n_{G\text{ Oil}}$	7.000 1/min	Limiting speed for oil lubrication
$n_{G\text{ Grease}}$	2.000 1/min	Limiting speed for grease lubrication
M_{RL}	0,5 Nm	Bearing friction torque
	0,534 kg	Weight

Mounting dimensions

$D_{a\text{ max}}$	43 mm	Maximum diameter of housing shoulder
$d_{a\text{ min}}$	28 mm	Minimum diameter shaft shoulder

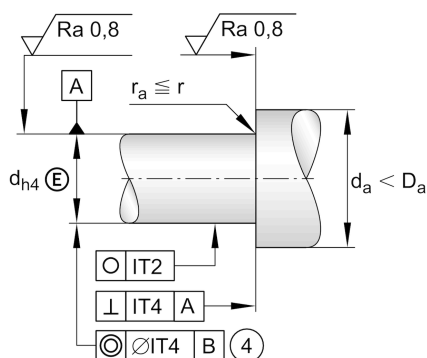
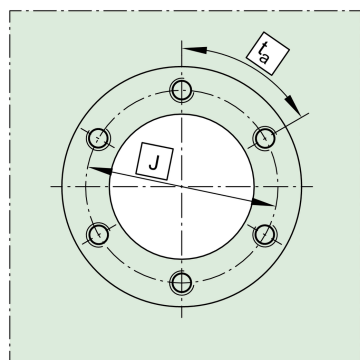
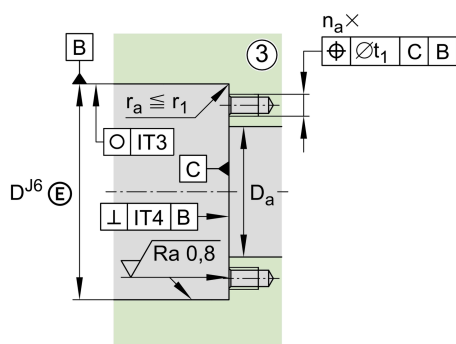

Dimensions

H_1	43 mm	Height outer ring over wave washer
C	14 mm	Width, outer ring
C_1	8 mm	Distance to lubrication hole
D_1	42 mm	Rip diameter shaft washer
D_2	30 mm	Heeldiameter wave washer long
D_3	40 mm	Outside diameter wave washer long
B	10 mm	Width, wave washer
B_1	24 mm	Width wave washer long
B_2	12 mm	Width heel wave washer long
r_{min}	0,3 mm	Minimum chamfer dimension
$r_{1 min}$	0,6 mm	Minimum chamfer dimension 1
d_1	3,2 mm	Diameter lubrication hole
J	53 mm	Pitch circle diameter (holes)
n	8	Number (screwing holes)
$n \times t$	45 °	Split

Temperature range

T_{min}	-30 °C	Operating temperature min.
T_{max}	120 °C	Operating temperature max.

Additional information

c_{aL}	1.800 N/ μ m	Rigidity axial
c_{kL}	230 Nm/mrad	Tilting stiffness
M_m	0,683 kg*cm ²	Mass moment of inertia
	1 μ m	Axial runout
radial	ZMA20/38	Recommended INA precision locknut for radial locking (not included)
axial	AM20	Recommended INA precision locknut for axial locking (not included)
M_A	18 Nm	Tightening torque nut
	8.972 N	Required locknut force
	30X42X7	Rotary shaft seal to DIN 3760 (not included)
	M6	Size fixing screws DIN EN ISO 4762 10.9 (not included)
n_a	8	Number of screws
$na \times ta$	45 °	Division (screwing holes)